

DZGK Grease Lubricator(20702 pump)

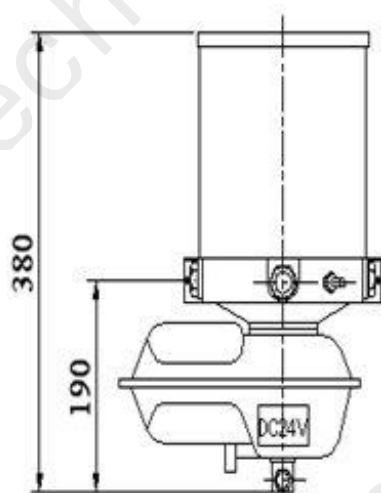

Two options: Plastic or aluminum

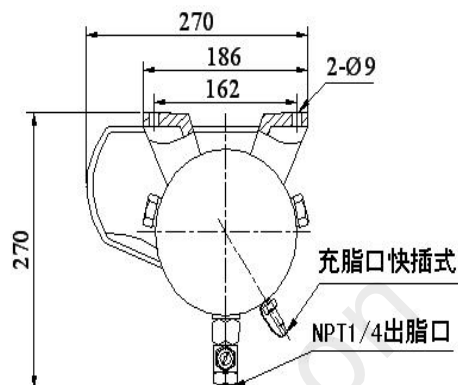

20702-Number of outlet

Note: Optional outlet threads M12 × 1.5 and Rp1/4 are available for your choice.
Please specify the outlet and reservoir at time of order.

Parameter:

Power voltage	12、24VDC
Timer	Timer-1、Timer-2 or without Timer
Motor Power	50W
Max. pressure	25MPa
Single outlet discharge	5.5ml/min
Number of outlet	1~3
Reservoir	2L (plastics) lubrication pump
Grease range	NLGI 000#~00#2
Protection	IP65
Interval	2 minutes to 15 hours
Running time	4 seconds to 37.5 minutes
Current	when loaded 3A
Usage	Heavy duty
	lubrication system

Timer-1:

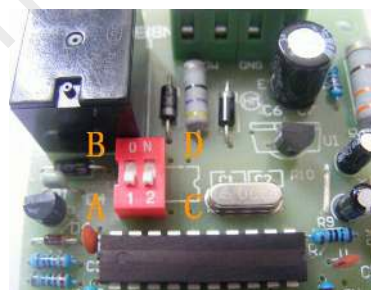

Working Time

A: Working time (Second)				B: Working time (mins)			
Item	Time	Item	Time	Item	Time	Item	Time
0	4	8	64	0	1	8	20
1	8	9	72	1	2.5	9	22.5
2	16	A	80	2	5	A	25
3	24	B	88	3	7.5	B	27.5
4	32	C	96	4	10	C	30
5	40	D	104	5	12.5	D	32.5
6	48	E	112	6	15	E	35
7	56	F	120	7	17.5	F	37.5

Stop Time

C: Stop (min)				D: Stop (Hours)			
Item	Time	Item	Time	Item	Time	Item	Time
0	2	8	32	0	0.5	8	8
1	4	9	36	1	1	9	9
2	8	A	40	2	2	A	10
3	12	B	44	3	3	B	11
4	16	C	48	4	4	C	12
5	20	D	52	5	5	D	13
6	24	E	56	6	6	E	14
7	28	F	60	7	7	F	15

Note: 1.Factory setting: working on Second and stop on minute.

2. If you want to working on mins or stop on hours,you can adjust the key position.

Parameter

Output: 24VDC±10%

Power: 60VA

Working temperature: -10~50°C



Timer-2:

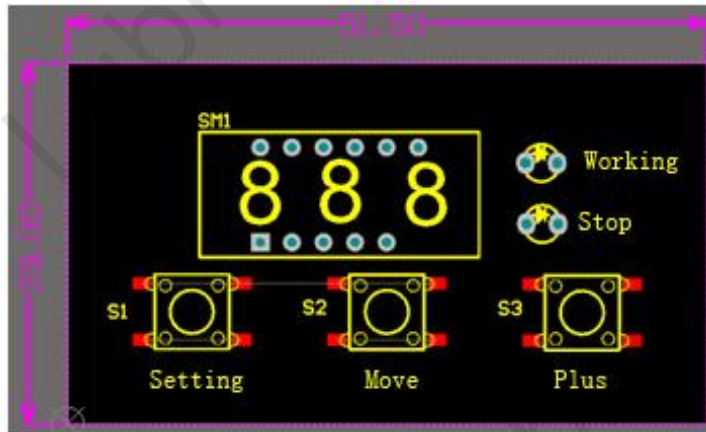
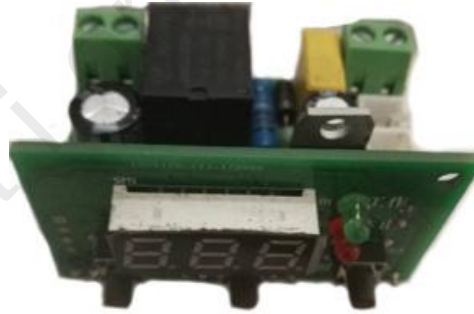

Main Function Explain:

- 1、 Working time:1-999s ;
- 2、 Idle time:1-999m;
- 3、 The timer can work with the low level switch(switch off when the grease empty),The switch will work again after the grease filled.
When the grease close empty,the timer will alarm and show “ERO” .Fill the grease and the pump will work again.
- 4、 You can operate the pump by press the button.
- 5、 The timer have the power off memory function,If the pump is powered off when it's stop,the pump will work from the stop time.
If the pump is powered off when working,the pump will work again once power on.

How to set the timer

1 st step	Press “setting” for 3 seconds	Setting the working time “T1”(the working light is on)	Press the “move” and “plus”button to set the number
2 nd step	Press the “setting”	Setting the stop time “T2”(the stop light is on)	Press the “move” and “plus”button to set the number
3 rd step	Press the “setting”	finished	

Voltage: DC24V±5V;

Power: Max.3W;

Temperature:-40-85℃;

Output power:<50W;

Complete piston(Pump element) with relief valve.



Figure	Material	Name.	Part No.	Stud Φ
	Steel	Pump Valve	207001	
	Steel	Relief Valve	207002	
	Steel	Coupling	207003	PT1/4- $\Phi 6$

Popular 20702 Models

Part No	Model	Outlets	Voltage (V)	Timer
207021120	P20702-1N-12V-0T	1	12VDC	0
207022121	P20702-2N-12V-1T	2	12VDC	1
207022241	P20702-2N-24V-1T	2	24VDC	1
207023242	P20702-3N-24V-2T	3	24VDC	2

Identification Code Pump Models 20702

Examples for Model Designation

P20702 - 1N - 12V - 0T
P20702 - 1N - 12V - 1T
P20702 - 2N - 24V - 1T
P20702 - 3N - 24V - 2T

Grease pump models:

Number of outlet:

X=1-3

standard=1

Operating Voltage:

X=DC12V,24V,

Timer Design:

without timer X=0

timer-1 X=1

timer-2 X=2

DZG Grease Lubricator(20703 pumps)

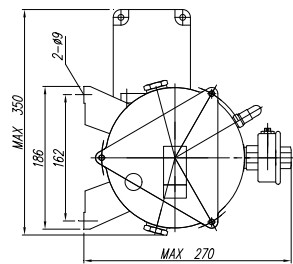
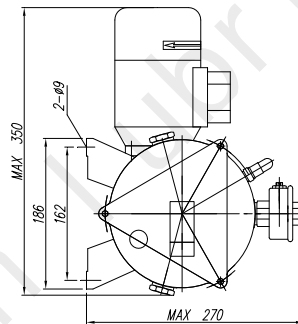
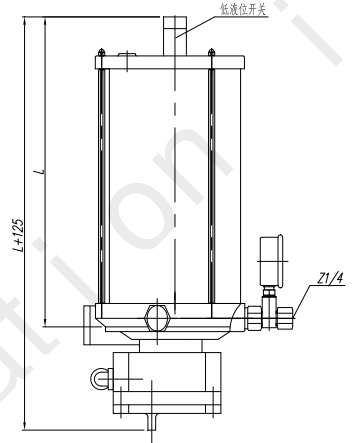
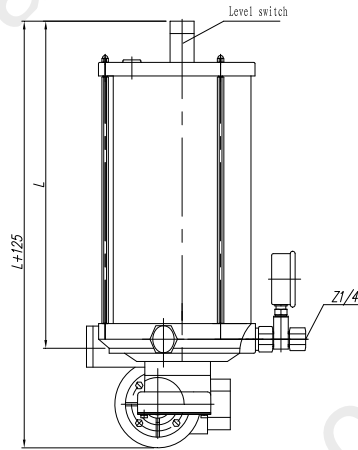

6L with Level Switch

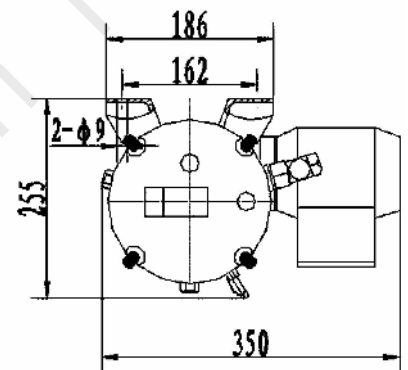
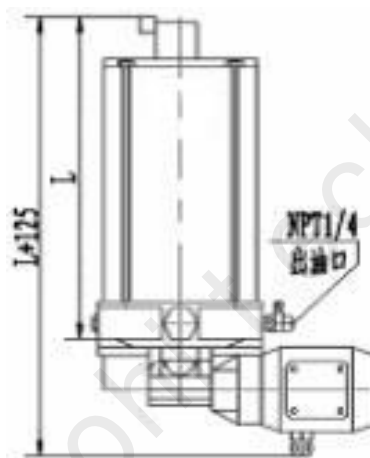

6L with Alu Reservoir

20703 Pumps

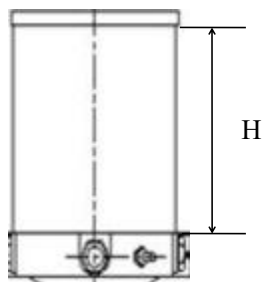

Height of Reservoir (L)	2.5	3	4	5	6	8	10	12
H(mm)	186	269	308	358	408	508	608	708

The 20703 centralized lubrication pump is a powerful and robust compact multi-line pump that can drive up to 3 elements and is used in progressive (Quicklub or Modular Lube) automated lubrication systems. It is perfect for mobile applications, small and medium sized machinery and general industries. Versatile, compact and economical, this pump can be enhanced with low-level control and printed circuit board that allow for controlling the lubrication cycles.

The family of 20703 pumps includes 12 and 24VDC, 220 and 380VAC. They are available with 1, 2 or 3 elements in with an adjustable output element. Reservoir sizes are 2.5, 3, 4, 5, 6, 8, 10 or 12 liters. Refer to the pump identification code for a complete listing of available pump configurations.

Popular 20703 Models

Part No	Model	Voltage (V)	Reservoir (L)	Timer	Level switch	Discharge per stroke (ml/min)
125241010	P20703-1N-25L-24V-1T-0S-T-0M	24VDC	2.5	yes	no	5.5
125241115	P20703-1N-25L-24V-1T-1S-T-5M	24VDC	2.5	yes	yes	5.5
225241100	P20703-2N-25L-24V-1T-1S-D-0M	24VDC	2.5	yes	yes	5.5
33241000	P20703-3N-3L-24V-1T-0S-D-0M	24VDC	3	yes	no	5.5
14241110	P20703-1N-4L-24V-1T-1S-T-0M	24VDC	4	yes	yes	5.5
14240010	P20703-1N-4L-24V-0T-0S-T-0M	24VDC	4	no	no	5.5
142201015	P20703-1N-4L-220V-1T-0S-T-5M	220VAC	4	yes	no	3
15241005	P20703-1N-5L-24V-1T-0S-D-5M	24VDC	5	yes	no	5.5
16241100	P20703-1N-6L-24V-1T-1S-D-0M	24VDC	6	yes	yes	5.5
162200015	P20703-1N-6L-220V-0T-0S-T-5M	220VAC	6	no	no	3
182201105	P20703-1N-8L-220V-1T-1S-D-5M	220VAC	8	yes	yes	3
183801015	P20703-1N-8L-380V-1T-0S-T-5M	380VAC	8	yes	no	3
1102200000	P20703-1N-10L-220V-0T-0S-D-0M	220VAC	10	no	no	3
1123801115	P20703-1N-12L-380V-1T-1S-T-5M	380VAC	12	yes	yes	3

Indentification Code Pump Models 20703

Examples for Model Designation

P20703 - XN - XL - XV - XT - XS -T/D - XM
P20703 - 1N - 25L - 24V - 1T -1S - T - 5M
P20703 - 3N - 3L - 24V - 0T -0S - D - 0M
P20703 - 1N - 4L - 220V - 1T - 0S - T - 0M
P20703 - 1N - 8L - 380V - 0T - 1S - D - 5M

Grease pump models:

Number of outlet:

X=1-3

standard=1

Reservoir Design:

X=2,3,4,5,6,8,10L

Operating Voltage:

X=DC24V,AC220V,AC380V

Timer Design:

without timer X=0

time X=1

Level Switch:

without level switch X=0

with level switch X=1

T/D Design:

T=filling from top

M Design:

Without cable M=0

With 5M cable M=1

TC-2 Controller

HLGC-1 is designed for controlling and monitoring of centralized lubrication systems of engineering machinery, chassis and lubrication stations. The control unit use LCD to display information.

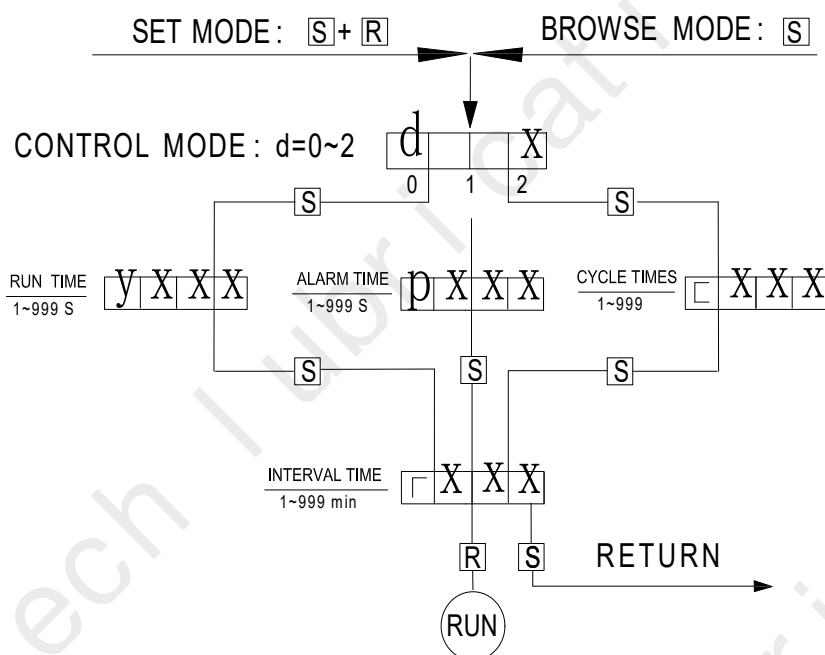

Model	P.N.	Voltage(V)	Timer
TC-2	HLGC-1	24VDC	YES
TC-2	HLGC-2	220VAC	YES

Y6020 Electric grease pump

Drum electric grease pump can be connected with battery (DC-24V) of the engineering machinery, easy to use, the output pressure is high, the output is adequate. As the special products of excavator, it's economic enough when repairing the engineering machinery. Widely used in ports, mines, steel mills stone field, garages, specialized in the field of manufacturing production line and so on many products. 220V Drum electric grease lubrication pump can be inserted into the grease barrel directly in the workshop without air source, so as to prevent oil from the oil into the machine barrel, more easy and convenient to use.

Application:

For high viscosity grease injection.

Suitable for all kinds of power machine grease injection especially in Mining area, building area, earth moving area.

Power supply AC220V/DC24V/DC12V

Barrel capacity: 20-30L

Output capacity : 0.6L/min

Output pressure : <350kg

Grease range: NLGI 000#~00#3

Weight : 25kg

Drum inner diameter : 280-320mm

