



VSG Dual-Line Distributors (40MPa)

Working Principle

The VSG-KR type dual-line distributor features oil ports on both its top and bottom. It ejects oil alternately from these ports during the forward and reverse movements of the piston. This distributor has a combined oil discharge structure within both sets of oil ports. Adjusting the orientation of the guide sleeve can change the odd-numbered oil output. The distributor's function can be directly observed through the movement of the indicator rod. Additionally, the oil volume for each outlet can be conveniently adjusted within a specified range via a screw. This distributor is suitable for dry oil centralized lubrication systems with a nominal pressure of 40MPa, and it distributes grease to lubrication points in a controlled manner, powered by alternating pressures from two main oil supply lines.

Parameter

Pressure: 40MPa

Discharge: 0-2.3ml/cyc

Adjustable: 0.14ml/turn

Note: The lubrication system is designed for use with greases having a penetration of no less than 265 (25 ° C, 150g) 1/10mm (NLGI 0# to 2#) and oils with a viscosity grade greater than N68. It operates in temperatures ranging from -10 ° C to 80 ° C. When using lubricating oil, it is advised to operate under a pressure of 20MPa.

Dimension

| 型 号 | VSG2-KR | VSG2-KR | VSG2-KR | VSG2-KR |
|--------|---------|---------|---------|---------|
| 出油口数 | 2 | 4 | 6 | 8 |
| L (mm) | 44.5 | 76 | 108 | 140 |

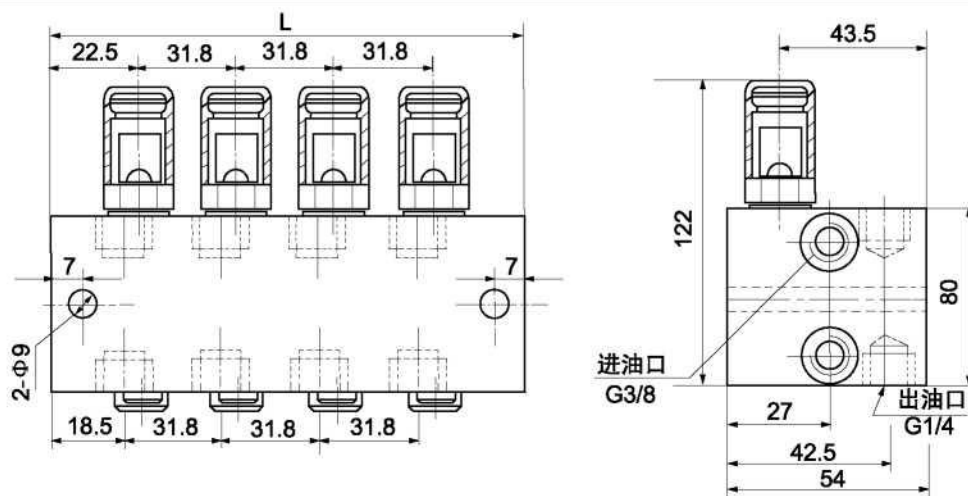

Usage Instructions:

To merge the upper and lower outlets, unscrew the screw in the hole and seal the unused outlet (either top or bottom) with a G1/4 plug to prevent dust intrusion.